

AiM InfoTech

FORD
Fiesta Rally3-4

Release 1.00



ECU



1

Models and years

This document explains how to connect AiM devices to the proper vehicle CAN data stream.
Supported models and years are:

- | | | |
|---------------|---------------|-----------|
| • Ford MSport | Fiesta Rally3 | from 2021 |
| • Ford MSport | Fiesta Rally4 | from 2020 |
| • Ford MSport | Fiesta R2 | from 2019 |

2

ECU CAN connection

These car models feature a CAN1 data bus accessible to AiM devices through the CAN Break-Out connector (DTM06-2S / DTM04-2P).

Here below is **CAN1 connector pinout** as well as their location – for Rally4 on the left and for Rally3 on the right:

Pin	Pin function	Wire colour	AiM cable	AiM wire color
1	CAN Low	Blue	CAN -	Blue
2	CAN High	Red	CAN +	White

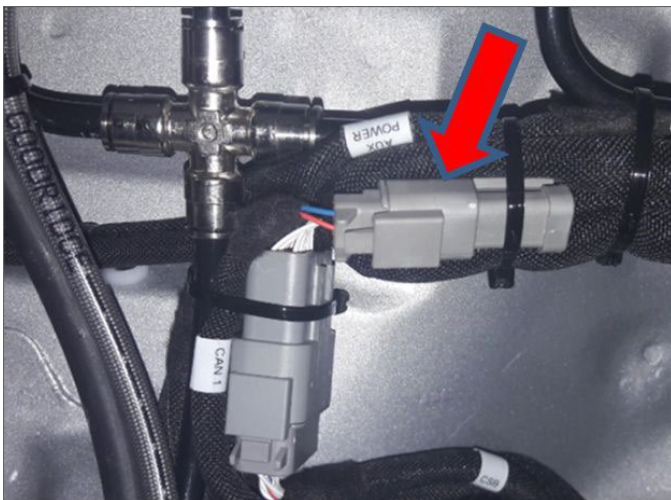

3

Race Studio configuration

Before connecting AiM device to the ECU set all functions up using AiM **Race Studio 3 software only**. The parameters to set in the device configuration are:

- ECU manufacturer: **FORD**
- ECU Model: **Fiesta Rally3-4** (Race Studio 3 only)

4

“FORD – Fiesta Rally3-4” Protocol

Channels received by AiM devices configured with " FORD – Fiesta Rally3-4" protocol are:

CHANNEL NAME	FUNCTION
EngineSpeed	RPM
PedalPosition	Throttle pedal position
StageMode	Anti lag system (Road – NoALS – ALS1 – ALS2 -ALS3)
Gear	Engaged gear
GearVoltage	Gear barrel voltage
Vehicle Speed	Vehicle speed
BrkPressF	Front brake pressure
BrkPressR	Rear brake pressure
Steer Wheel Ang	Steering wheel angle position

Please note: not all data channels outlined in the ECU template are validated for each manufacturer model or variant; some of the outlined channels are model and year specific, and therefore may not be applicable.